

7445

Combi-Cam Ultra Series: 4-Dial Dual Access Combination Cam Lock

SPECIFICATIONS

Keyless/Combination: 4-dial combination cam/locker lock with key override and code retrieval capability offering convenient keyless access.

Resettable: Set the combination in three easy steps. Up to 10,000 possible combinations.

Installation: Can be installed vertically (door) or horizontally (drawer).

Barrel diameter: 3/4"

Cylinder lengths: 5/8", 7/8" or 1-1/8"

Body: Heavy duty die cast metal construction

Cam: Includes dual hole, 1-1/2" long straight cam for use in door or drawer applications.

Cam rotation: 90° stop cam placement allows cam to rotate 90° to the left or right.

Finish: Chrome or Black

Packaged: 20 per box / 100 per case

KEYING INFORMATION

Keyway: Tubular keyway. The Override Key allows for override or retrieval of the current combination. One key controls all locks in the same key code group.

Keys: Override keys are NOT included with locks. Order separately as required.

Override keying: Keyed alike

INCLUDED ACCESSORIES

Pronged wood washer, fixing nut, 90° stop cam, cam screw and lock washer, 1-1/2" dual hole, straight cam.

OPTIONAL ACCESSORIES

7445-KEYS: Override keys (set of 2). Specify key code when ordering.

100 Series Cams: Straight and offset dual-hole cams (See page 2)

| Item | Finish | Cyl. Length | Fits Max. Material Thickness | Override Key Code |
|---|--------------------------------------|-------------|------------------------------|-------------------|
| 7445S-KA374 | Chrome | 5/8" | 3/8" | #374 |
| 7445S-KA401 | Chrome | 5/8" | 3/8" | #401 |
| 7445S-BLK-KA168 | Black | 5/8" | 3/8" | #168 |
| 7445S-BLK-KA401 | Black | 5/8" | 3/8" | #401 |
| 7445M-KA374 | Chrome | 7/8" | 5/8" | #374 |
| 7445M-BLK-KA374 | Black | 7/8" | 5/8" | #374 |
| 7445L-KA374 | Chrome | 1-1/8" | 7/8" | #374 |
| 7445L-BLK-KA374 | Black | 1-1/8" | 7/8" | #374 |
| 7445L-BLK-KA401 | Black | 1-1/8" | 7/8" | #401 |
| Override Keys are not included with locks — order separately as required (sold as a set of 2) | | | | |
| 7445-KEYS | Override keys KA #168, #374, or #401 | | | |

7445

Function: Cabinet door or drawer dual access combination lock

Locking: 4-dial with key override

Barrel lengths: 5/8", 7/8" or 1-1/8"

Finish: Chrome or Black



Chrome

Override Keys
sold separately.



Includes:

Pronged wood washer, fixing nut, 90° stop cam, cam screw and lock washer, and 1-1/2" dual hole straight cam.



Black

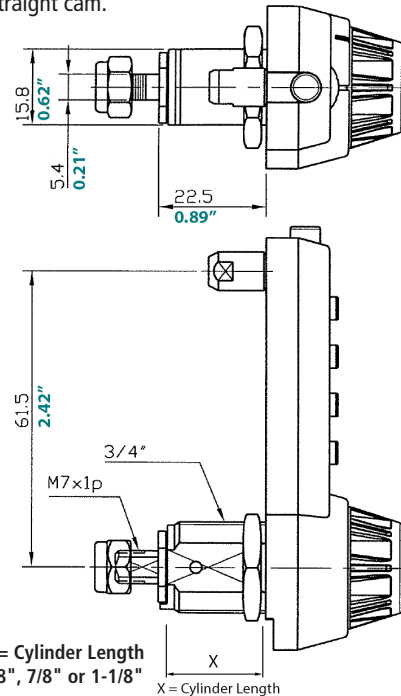

X = Cylinder Length

5/8", 7/8" or 1-1/8"

X = Cylinder Length

Millimeters
Inches

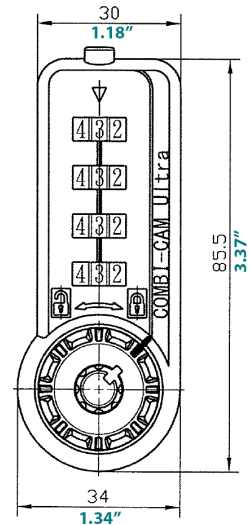

The Combi-Cam Ultra™ dual-access combination locker lock offers key override AND patented code discovery. Manager key overrides locks when codes are forgotten, an employee leaves, etc. Code discovery allows the code to be discovered so that the combination can be set to a new code.



WARNING: This product can expose you to chemicals including chromium, which is known to the State of California to cause cancer and birth defects or other reproductive harm. For more information go to www.P65Warnings.ca.gov.

P65Warnings.ca.gov.

MOUNTING CUTOUT

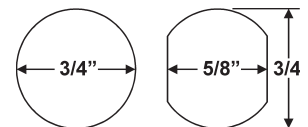

OLYMPUS
LOCK
INC

7445

Combi-Cam Ultra Series: 4-Dial Dual Access Combination Cam Lock

OPTIONAL CAMS

100 SERIES — STRAIGHT CAMS

For use with 7445 Combi-Cam Ultra

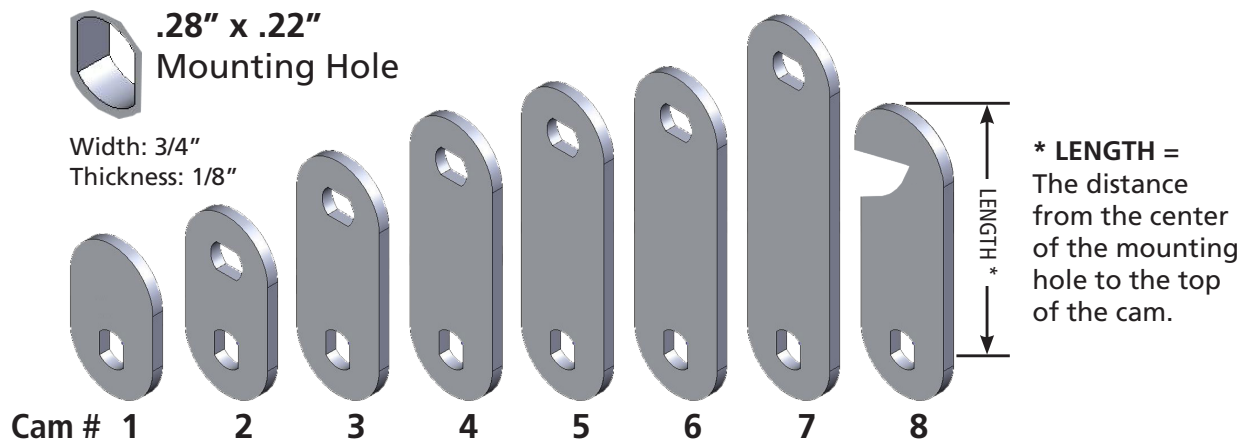

| Cam # | SKU | Length * |
|-------|---------|----------|
| 1 | 130049 | 5/8" |
| 2 | 130050D | 3/4" |
| 3 | 130031D | 1-1/8" |
| 4 | 130147D | 1-1/4" |

| Cam # | SKU | Length * |
|-------|-----------|----------|
| 5 | 130023D | 1-1/2" |
| 6 | 130058 | 1-5/8" |
| 7 | 130056D** | 2" |
| 8 | PL32001 | 1-1/4" |

** 130056D is available via special order. Requires minimum purchase of 20 pcs.

100 SERIES — OFFSET CAMS

For use with 7445 Combi-Cam Ultra

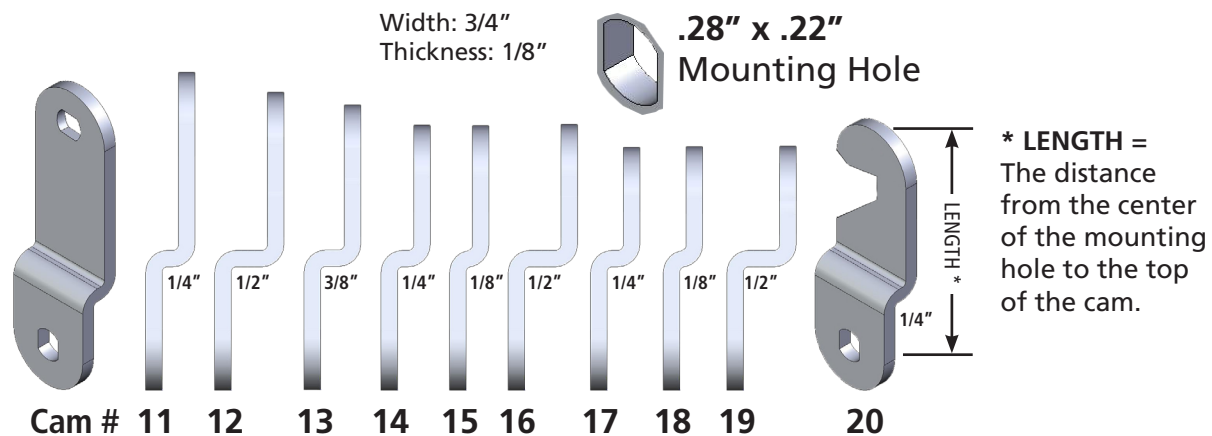

| Cam # | SKU | Length * | Offset |
|-------|----------|----------|--------|
| 11 | 30597D | 2-1/4" | 1/4" |
| 12 | 30596D | 2" | 1/2" |
| 13 | 30002D | 1-5/8" | 3/8" |
| 14 | 30026D | 1-1/2" | 1/4" |
| 15 | 30025D** | 1-1/2" | 1/8" |

| Cam # | SKU | Length * | Offset |
|-------|----------|----------|--------|
| 16 | 30027D** | 1-1/2" | 1/2" |
| 17 | 30594D | 1-1/4" | 1/4" |
| 18 | 30593D** | 1-1/4" | 1/8" |
| 19 | 30595D | 1-1/4" | 1/2" |
| 20 | PL39001 | 1-1/2" | 1/4" |

** 30025D, 30027D, 30593D are available via special order. Requires minimum purchase of 20 pcs per item.