

# ETS1-PL SERIES

U.S. Patent No.  
D490,686 S

*Cabinet Pull for use with Olympus  
Large Pin 1-1/8" Barrel Diameter Cabinet Locks*

## SPECIFICATIONS

The ETS1-PL cabinet pull works with our existing ETS Series hardware and provides a built-in cabinet pull in addition to the through-bolt mounting achieved with the use of the ETS1 trim spacer. This product provides added security and flexibility to our line of door and drawer cabinet locks and can be used in combination or separately for variety of configurations.

Use with 700, 721, 754, 777, 800, 850, 854, 888, 931, 950, L72V, L92V

- ETS1-125 - 1/8" through-bolt plate
- ETS1-250 - 1/4" through-bolt plate
- ETS1-PL - Cabinet pull
- ETST1 - Template

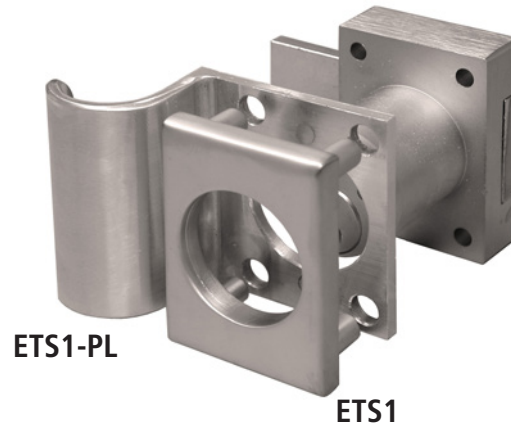

ETS1-PL

ETS1



ETS1-PL Requires use of either  
ETS1-125 or ETS1-250

## ETS1 / ETS1-PL

For 1-1/8" diameter lock nos. 700, 721, 754, 777, 800, 850, 854, 888, 931, 950

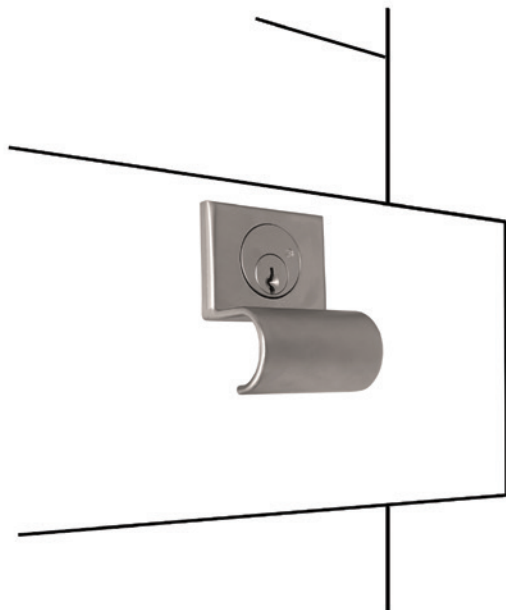

**OLYMPUS  
LOCK**  
INC

# ETS1-PL SERIES

## Cabinet Pull for use with Olympus Large Pin 1-1/8" Barrel Diameter Cabinet Locks

### ETS1-PL Cabinet Pull

- The ETS1-PL fits between our ETS1 through-bolt mounting plate and the face of the cabinet
- When combined with our ETS, it provides through-bolt mounting of cabinet lock and pull in a single unit
- Works in both door or drawer applications
- If mounted "pull down" in drawer applications, the pull will protect the face of the cabinet from the wear and tear of hanging keys
- Works with existing ETS hardware and screws
- Available in US3 and US26D finishes

### ETS1 Through-Bolt Mounting Plate

- The external metal 1/8" or 1/4" through-bolt mounting plate allows for an attractive flush mounting of the cabinet lock face

- Increases security of installation through reinforcement of cabinet face and direct connection of lock mounting screws to through-bolt mounting plate's binder posts
- Available in US3 and US26D finishes
- Includes mounting screws

### ETST1 Template for Through-Bolt Mounting Plate

- Allows for proper mounting hole placement of Reinforcing Trim Spacer
- Can be used as a 1/8" shim spacer
- Available in US3 and US26D finishes

### For use with:

Olympus locks 700, 721, 754, 777, 800, 850, 854, 888, 931, 950

- ETS1-PL - Cabinet pull
- ETS1-125 - 1/8" thick through-bolt mounting plate
- ETS1-250 - 1/4" thick through-bolt mounting plate
- ETST1 - Spacer template



U.S. Patent No. D490,686 S



## ETS1-PL Cabinet Pull

Below illustrations do not represent all possible configurations.

